



greencAPITAL
Realty Advisors

Commercial Real Estate
 and Construction Services

MEDICAL OFFICE SPACE

2000 N. Federal Highway

Pompano Beach, FL 33062

For more information
 please contact:

Steven A. Leeds

Licensed Real Estate Broker
 Certified Building Contractor

2799 NW 2nd Avenue
 Suite 213
 Boca Raton, FL 33431

561.998.2427

561.465.2034

Steve@greencapitalrealty.com

Greencapitalrealty.com



➤ 10,371 SF Office/ Medical building

➤ 1,000 SF - Suite 201

- ❖ Well maintained office/medical building
- ❖ Long term co-tenants
- ❖ Local management
- ❖ 4 Exam Rooms & Lab
- ❖ Private Restroom
- ❖ Recently renovated interior

Building

Available Space

Features

www.greencapitalrealty.com

Subject to errors, omissions, prior withdrawal, lease or sale without notice



greenCAPITAL Realty Advisors

Commercial Real Estate
and Construction Services

Aerial Map

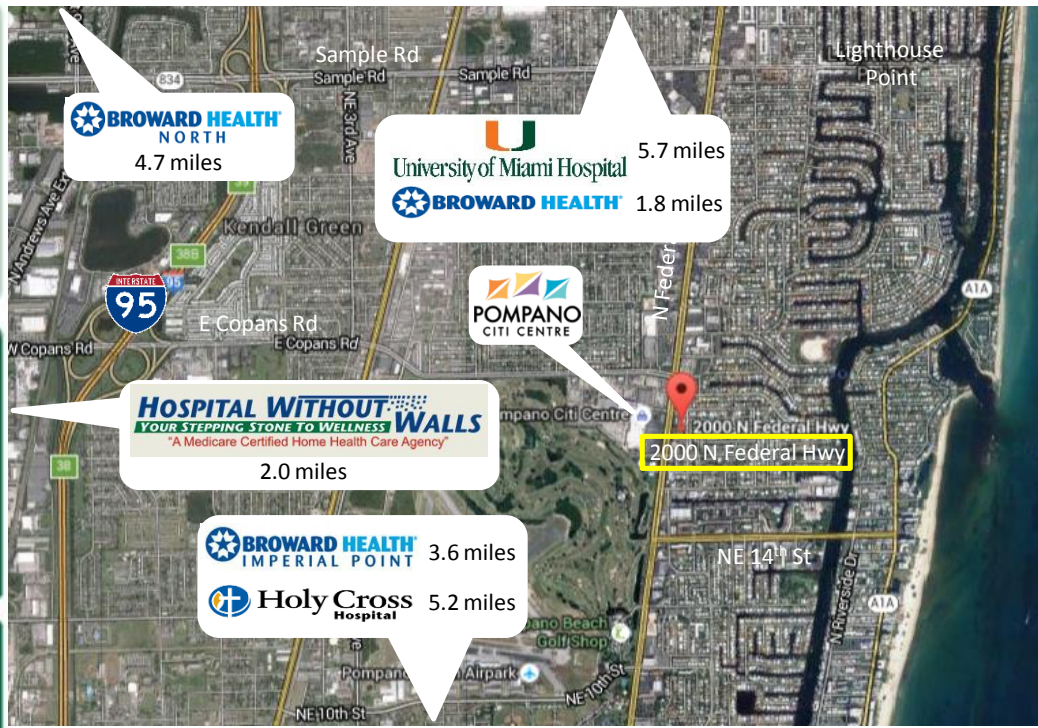

Demographics

2015	1 mile	3 mile	5 mile
Daytime Population:	12,267	115,278	283,604
Average Income:	\$78,719	\$66,883	\$63,592
Average Age:	47	44	45

Floor Plan

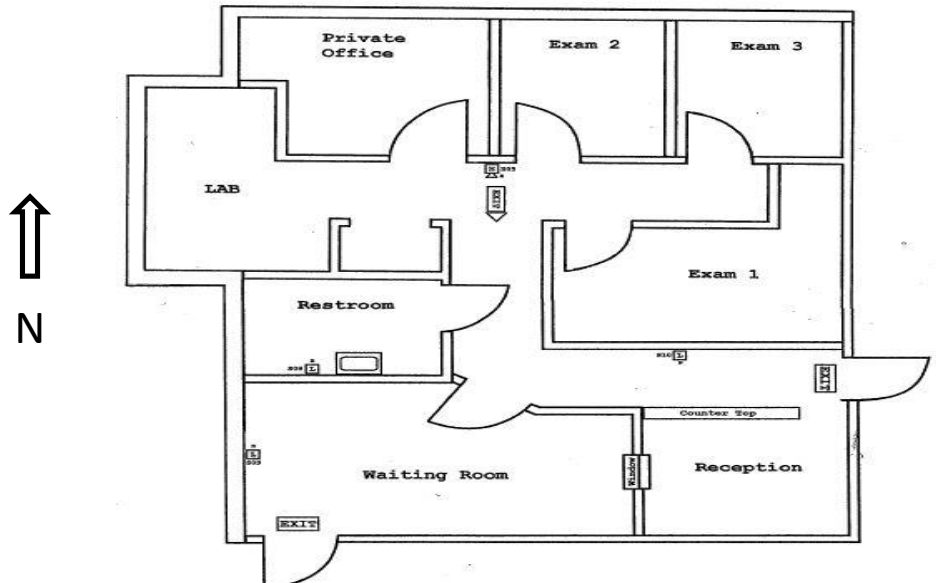

www.greencapitalrealty.com

Subject to errors, omissions, prior withdrawal, lease or sale without notice